

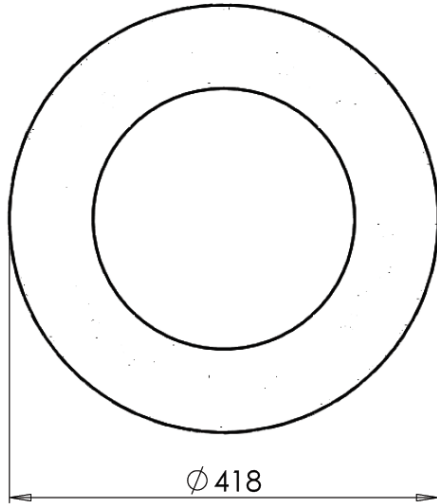

# FILTERMIST - FUSION FILTER



<b>SDA2300</b>			
AIRFLOW (M <sup>3</sup> /HR)	UNIT ATTACHED	50Hz	60Hz
	S400	412	490
	S800	776	931
WEIGHT (KG)	6		
FILTER CLASSIFICATION (EN 1822:2009)	E10*		
SUITABLE FOR....	FILTERMIST SERIES 6 & 7: F250, F275 & F7 FILTERMISTXCEL: FX2000 FILTERMISTXCEL2: FX2000 & FX3000 S SERIES: S400 & S800		

\*Filter tested by independent test house.

